

REV	FCN	DESCRIPTION	DRAWN BY	DATE	APPR
A00	E268047	INITIAL RELEASE	LIJUAN WANG	20240913	NEO SI
A01	E290955	SEE ECO	CHRIS HENG	20251001	LIJUAN WANG

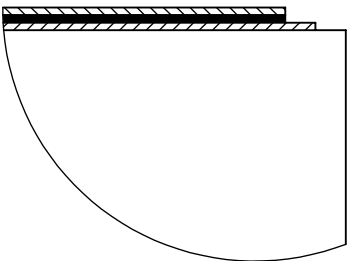
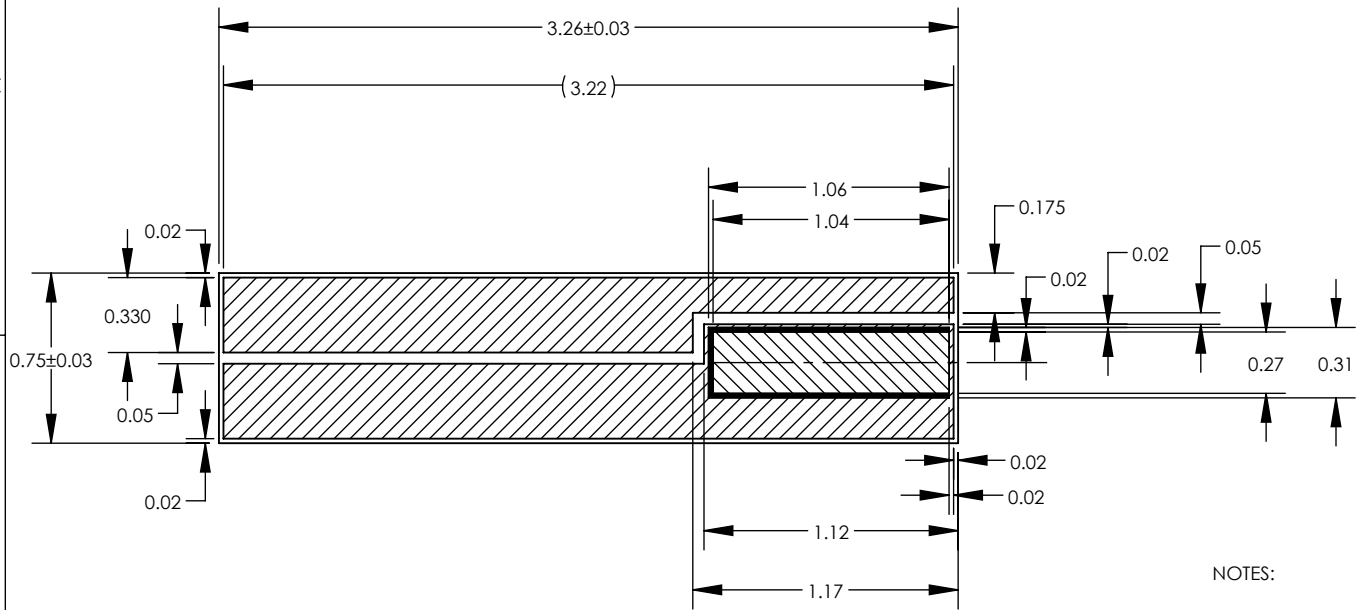

DETAIL A
SCALE 200 : 1

NOTES:

- SUBSTRATE MATERIAL IS ALN (230 W/mK).
THICKNESS DOES NOT INCLUDE METALLIZATION.
POLISHED AT TOP AND BOTTOM SURFACE. ROUGHNESS: Ra < 50nm
- METALLIZATION TO BE THIN FILM.
- METALLIZATION:
TOP-SIDE: Ti: 0.06 NOM; Pt: 0.2±0.04um; Au:≥2um
Pt 0.32±0.064um OR APPROVED EQUIVALENT
AuSn (Au=73±5wt%/4.0±0.8um) + Au FLASH 0.06um NOM
- BURRS: 0.05mm MAX.
- PART MUST BE RoHS COMPLIANT.
- PARTS TO BE SHIP BY TRAY.
- ELEMENT ANALYSIS IS SUFFICIENT TO GUARANTEE THE PRESENCE OF METALLIZATION.
METALLIZATION THICKNESS MEASUREMENT NOT NEEDED.
- NO BLISTERING ON METALLIZATION AFTER TEST ON HOT PLATE AT 350 C 10C IN AIR.
- USE THE DXF DRAWING FOR ALL DIMENSIONS NOT CALLED OUT.
- PROBE MARK PERMITTED, WHILE NOT EXPOSING BASE MATERIAL.



PART NUMBER	1481244	DRAWN	CHRIS HENG	DATE	20240913	<div>COHERENT</div> <div>SUBSTRATE,AL-N, 3.26X0.75X0.5MM, CW LASER,230</div>		
MATERIAL	SEE NOTE	CHECKED	LIJUAN WANG	DATE	20240913			
FINISH	SEE NOTE	RESP ENG	NEO SI	DATE	20240913			
COHERENT CONFIDENTIAL		UNLESS OTHERWISE SPECIFIED: DIMENSIONS ARE IN MILLIMETERS TOLERANCES ARE: 						